

JACK

China No.1

Shanghai stock
listed



Full Automatic Drive Roller Post Bed Sewing Machine With Top and Bottom Feed



S5

The applications of Post Bed Roller Feed Sewing Machine: Bags, gloves, hats, wallets, riding boots, sports shoes, superior leather shoes, etc.

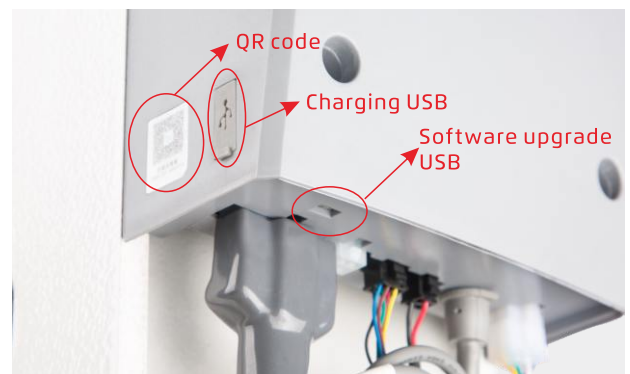

1 Embedded operation panel

- 1.Voice guide, Automatic broadcast failure and solution, easy to learn and easy to use;
- 2.Able to reset user parameters as needed, more humanization, do not worry about disoperation.

2 Intelligent dual USB interfac,QR code new function

- 1.With standard charging and software upgrade USB port, it is very convenient to upgrade the electronic control software later.
- 2.QR code new function: uers can scan QR code through mobile phone to obtain information and related help and services

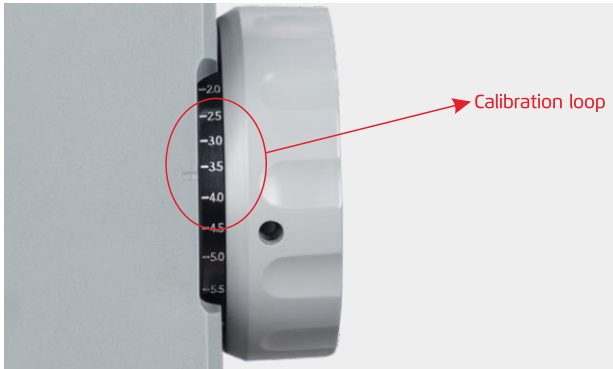

3 Aluminum handwheel with calibration loop

1. Fan blade has a good heat dissipation and longer service life of electronic components.
2. Finger print handwheel has better hand feel and accurate needle distance adjustment.



4 Stitch coincidence rate is 100%

Repeated stitch rate of front and back stitches are 100%, beautiful stitch, high yield.



5 Strong Puncture Ability

It can puncture A4 paper of more than 110 layers at one time, and easy to stitch the super thick fabric of labor protection shoes.

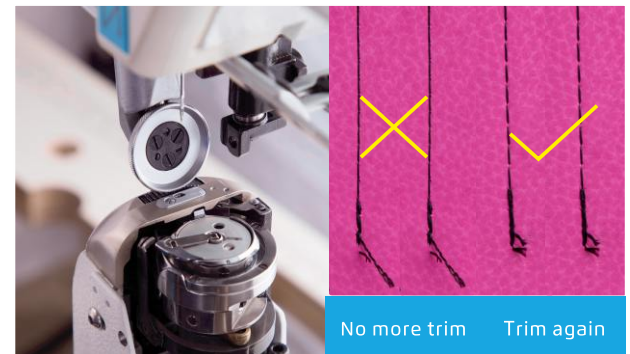

6 Short Thread Remaining (optional)

The innovative design of the thread trimming mechanism enables the tail within 3mm after thread trimming, no need to trim the thread tail, saving time and reducing labor costs.

Specification

Model	Max Speed (s.p.m)	Needle	Presser Foot Lifter Height (mm)	Max Stitch Length (mm)	Needle Bar Stroke (mm)	Automatic Thread Trimmer	Automatic Backstitch	Automatic Presser Foot Lifter	Short Tail	Volume (mm)	Weight (kg)
S5-91	3000	INDPX5#16	12	6.3	41	✓	✓	✓		812×375×724	67/76
S5-91CX	3000	INDPX5#16	12	6.3	41	✓	✓	✓	✓	812×375×724	67/76
S5-92	2000	INDPX5#16	12	4.1	41	✓	✓	✓		812×375×724	67/76



Jack Wechat



Jack Facebook